

MACHINE ROOM LESS - GEARLESS



MG200 - MG250 - MG340



Hoistway Section

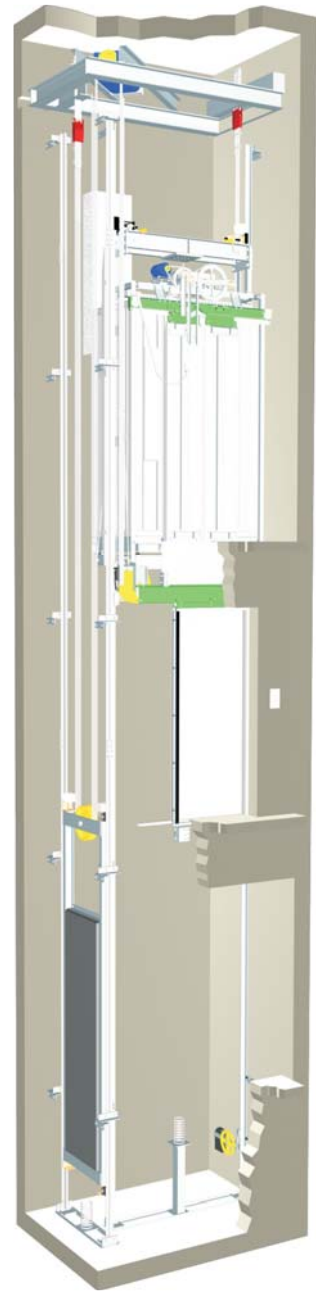
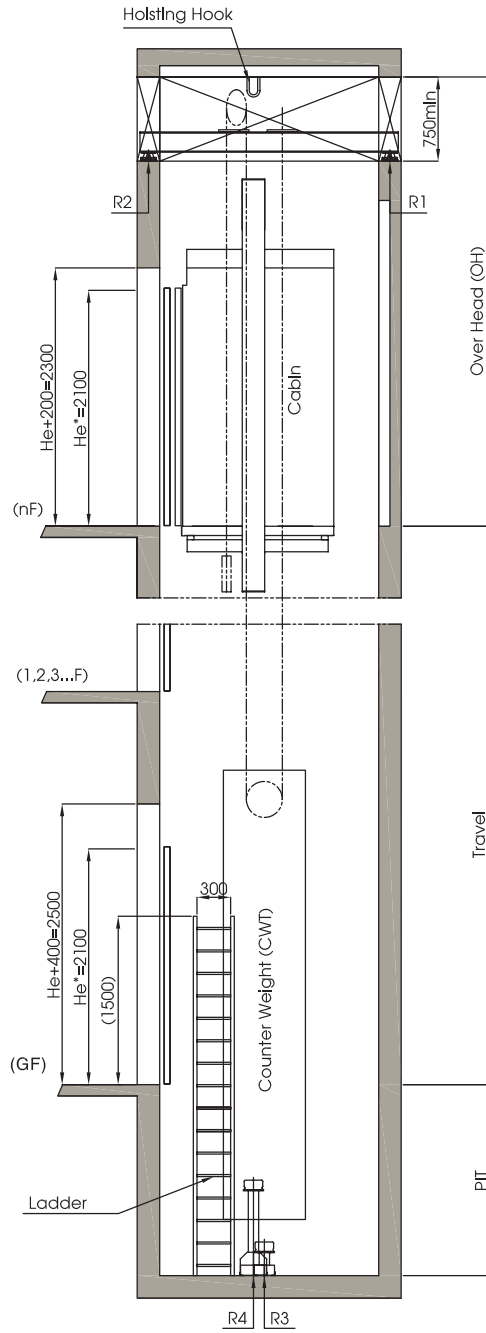

Hoistway hook

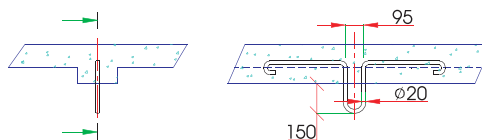

Note:

- He : Entrance height

Works by Builder:

- Ventilation
- Hoisting hook
- Ladder
- Openings at the top of hoistway
- Provision intermediate beams if floor height is over 3000mm
- Hoistway wall thickness where central panel installed should be 100mm
- Finished after the installation

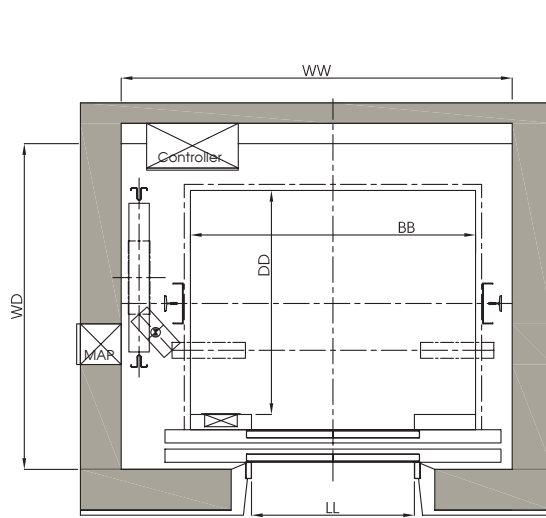

Section B-B

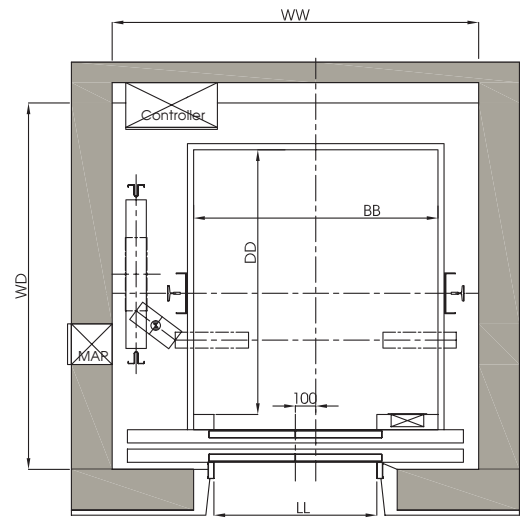

Section B-B

TECHNICAL DATA

Speed (m/min)	Type	Capacity (kG)	Entrance width LL (mm)	Car Size BB x DD (mm x mm)	Hoistway Size WW x WD (mm x mm)	Maximum travel height (m)	Main supply voltage 3x380 Vac ±10%	
							Motor (kW)	Nominal line current (A)
60	MRL - 320 - CO60	320	700	1200 x 800	1800 x 1300	40	3,0	8,9
	MRL - 450 - CO60	450		1400 x 850	1920 x 1350		3,4	10,6
	MRL - 600 - CO60	600	800	1200 x 1000	1800 x 1500		4,5	12,3
				1400 x 1100	1920 x 1600			
	MRL - 800 - CO60	800	900	1400 x 1400	1920 x 1900		6,1	15,3
	MRL - 1000 - CO60	1000		1600 x 1500	2150 x 1900		7,2	17,9
	MRL - 1250 - CO60	1250	1000	1800 x 1600	2450 x 2000		9,3	23,6
				1600 x 1900	2350 x 2300			
MRL - 1600 - CO60	1600	1100	2100 x 1600	2750 x 2000	12	25,5		
MRL - 2000 - CO60	2000	1000	1600 x 2200	2350 x 2600	14,2	34,4		
		1200	2350 x 1700	3100 x 2200				
96	MRL - 450 - CO96	450	800	1400 x 850	1920 x 1350	40	5,5	12,8
				1200 x 1000	1800 x 1500			
	MRL - 600 - CO96	600	800	1400 x 1100	1920 x 1600		7,4	17,2
				1200 x 1300	1800 x 1800			
	MRL - 800 - CO96	800	900	1400 x 1400	1920 x 1900		9,8	21,3
	MRL - 1000 - CO96	1000		1600 x 1500	2150 x 1900			
MRL - 1250 - CO96	1250	1000	1800 x 1600	2450 x 2000	15,2	31,7		
MRL - 1600 - CO96	1600	1000	1600 x 1900	2350 x 2300				
			1100	2100 x 1600	2750 x 2000	18,5	40,5	

No of starting per hour: 180

Speed (m/min)	PIT	OH
60	1500	4000
96	1700	4200

→ → → Gearless (GL) elevator uses an un-synchronous motor with permanent magnetic which have been appeared in the development countries for 10 years. More than ten thousand projects have used Gearless elevators on over the world to prove its advantages, the best advantages are the energy saving from 30% to 45%, the place saving, and the smooth operation.

→ → → With the good advantages of new high technology, we decided promptly to apply GL machines to Thien Nam elevators especially in Machine Room Less (MRL) in 2004, after 1 year testing and completion Thien Nam. In Jun 2005, we produced the first MRL at Thien Nam factory. Up to now Thien Nam has supplied more than 100 MRL with GL technology to the local market which assists using effective energy for the projects.

→ → → There are many luxury houses, low rise offices at Phu My Hung, a new urban in HCM City, using MRL elevators that do not capture a space for machine room at the top of the hoist way, MRL helps to solve the building problem of high limitation in this area, then the architects are also happy with the MRL solution which do not effect their architectural designs of roof building.

→ → → In 2008, we installed and put into operation of many Thien Nam elevators at high speed of 90 meters per minute. We will increase the speed of Thien Nam in 2010.

→ → → Thanks to compact space, so MRL saves space of the hoist way, increases its capacity, expands more its life-time, be safer, and more over saves energy that compares with Gear Series. The new solution of MG-200, MG-250 and MG-340 add more advantages of MRL elevators.

Head Office

1/8C Hoang Viet St.,
Ward 4, Tan Binh Dist.
Ho Chi Minh City
Tel: (84.8) 54490210 - 15
Fax: (84.8) 54490208 - 09

Ha Noi

119 Nguyen Ngoc Nai St.,
Thanh Xuan Dist.
Ha Noi City
Tel: (84.4) 3566 5759 - 61
Fax: (84.4) 3566 5763

Da Nang

48 Le Dinh Ly St.,
Thanh Khe Dist.
Da Nang City
Tel: (0511) 3829 015
Fax: (0511) 3897 969

Nha Trang

92C Le Hong Phong St.,
Nha Trang City
Khanh Hoa
Tel: (058) 3870111
Fax: (058) 3870112

Can Tho

97B1 Ung Van Khiem St.,
Ninh Kieu Dist
Can Tho City
Tel: (0710) 3762403
Fax: (0710) 3762430